



HOUSING AUTHORITY OF THE CITY OF HOBOKEN

# **HOBOKEN HOUSING FORWARD**

## INTERACTIVE DESIGN WORKSHOP SUMMARY

Sept 29, 2021

This is a summary of the preliminary planning study for the Authority's properties as presented during the three-day Interactive Design Workshops held on Mama Johnson Field. This study was used to present concepts and receive comments, recommendations, and questions.

# SCHEDULE FOR 9/29-OCT 1 MEETINGS

## WEDNESDAY SEPTEMBER 29

- Recap of Previous Meetings & Community Engagement, What We've Heard, Spectrum Introduction 6:00-7:00 PM
- Q&A/Wrap Up 7:00-7:30 PM

## THURSDAY SEPTEMBER 30

- Stakeholder Meetings 9:30-10:30 AM; 1:30-2:30 PM
- Open house 9:30 - 10:30 AM; 1:30-2:30 PM
- Q&A/Wrap Up 6:00-7:30 PM

## FRIDAY OCTOBER 1

- Clergy/RAD Board Meetings 9:30 AM-1:30 PM

NOTES

1. THE CONTENT OF THIS DOCUMENT IS CONFIDENTIAL AND INTENDED ONLY FOR THE USE OF THE HOUSING AUTHORITY OF THE CITY OF HOBOKEN.
2. IT IS STRICTLY FORBIDDEN TO SHARE ANY PART OF THIS DOCUMENT WITH ANY THIRD PARTY, WITHOUT A WRITTEN CONSENT OF THE HOUSING AUTHORITY OF THE CITY OF HOBOKEN.

# CHARETTE MEETINGS: SEPT 29 - OCT 1



**INTERACTIVE DESIGN WORKSHOPS**  
 SEPTEMBER 29, 2021  
**QUESTIONS**

1. 6-7 YEARS AGO PREVIOUS EX DIRECTOR MADE PLAN, WHY DIDN'T IT HAPPEN THEN? 20/20 VISION PLAN "RESIDENTS WANTED IT, CITY COUNCIL DIDN'T"
2. FLOODING - CHANGING FOR THE WIPER TO MANY NEW BUILDINGS, OLD PIPING, PIPE DRIVING. HURRICANE SANDY. LOSS OF ELECTRIC.
3. DISABILITY ISSUES.
4. ASKING FOR PLANS "IN BLACK & WHITE".
5. WE DON'T HAVE SAY SO IN WHAT HAPPENS AROUND OUR COMMUNITIES.
6. WHY PARK AT LIGHT RAIL?
7. COMMENTS ABOUT WHO IS "BEHIND" THIS EFFORT?
8. HAVING A VOICE.
9. WHY GENTRIFY THIS NEIGHBORHOOD?
10. NOT ANY OTHER SPACE IN HOBOKEN?

PAGE 1

**LISTENING & LEARNING FROM RESIDENTS**

Designing with a **holistic** and **community-focused** approach

9/30/21 **FIRST RESPONDERS MEETING**

Fire → Modern Building Code WILL ADDRESS MOST ISSUES  
 # ALARM SYSTEMS - CURRENTLY NO SMOKE CONTROL TODAY.

ELEVATOR SPENCER/ALARM SYSTEMS OUT OF FLOOD HAZARD -  
 RELOCATE PANS TO EASIER ACCESS

ELEVATORS.

o Dem - (NOT AID OF ANYTHING ABOVE 4 STORIES THAT EXISTS TODAY  
 TOO MANY CHARACTERISTICS OF ELEVATORS, ACCESS

SUMMER BUILDINGS HAVE MORE PART OF OWNERSHIP; SELF REGULATE

NEW MODERN CONSTRUCTION NEEDED - BUILDINGS ARE OUTDATED

COMMUNITIES ARE GASTROUR PLACES FOR DISASTERS; ESPECIALLY IN THE PM.

UPGRAVED STREET ACCESS - ELIMINATE LOOPS/IRREGULARITIES; BETTER STREET GRID ACCESS

RECREATION AREAS - CONSIDER LOCATION VS. VIS APARTMENTS - MAKE THEM MORE PUBLIC FACILITY; MAKE THEM MORE VISIBLE + ACCESSIBLE  
 ↳ OVERLOOK CAUS MIT UNDERGROUND



No one knows your home better than **you** do





- ① **ADAMS GARDENS**  
125 UNITS
- ② **CHRISTOPHER COLUMBUS GARDENS**  
97 UNITS
- ③ **ANDREW JACKSON GARDENS**  
598 UNITS
- ④ **HARRISON GARDENS**  
209 UNITS
- ⑤ **MONROE GARDENS**  
125 UNITS
- ⑥ **FOX HILL GARDENS \***  
200 UNITS \*

---

**1,354 UNITS**

\*FOX HILL GARDENS CURRENTLY UNDERGOING RENOVATIONS OF 200 UNITS



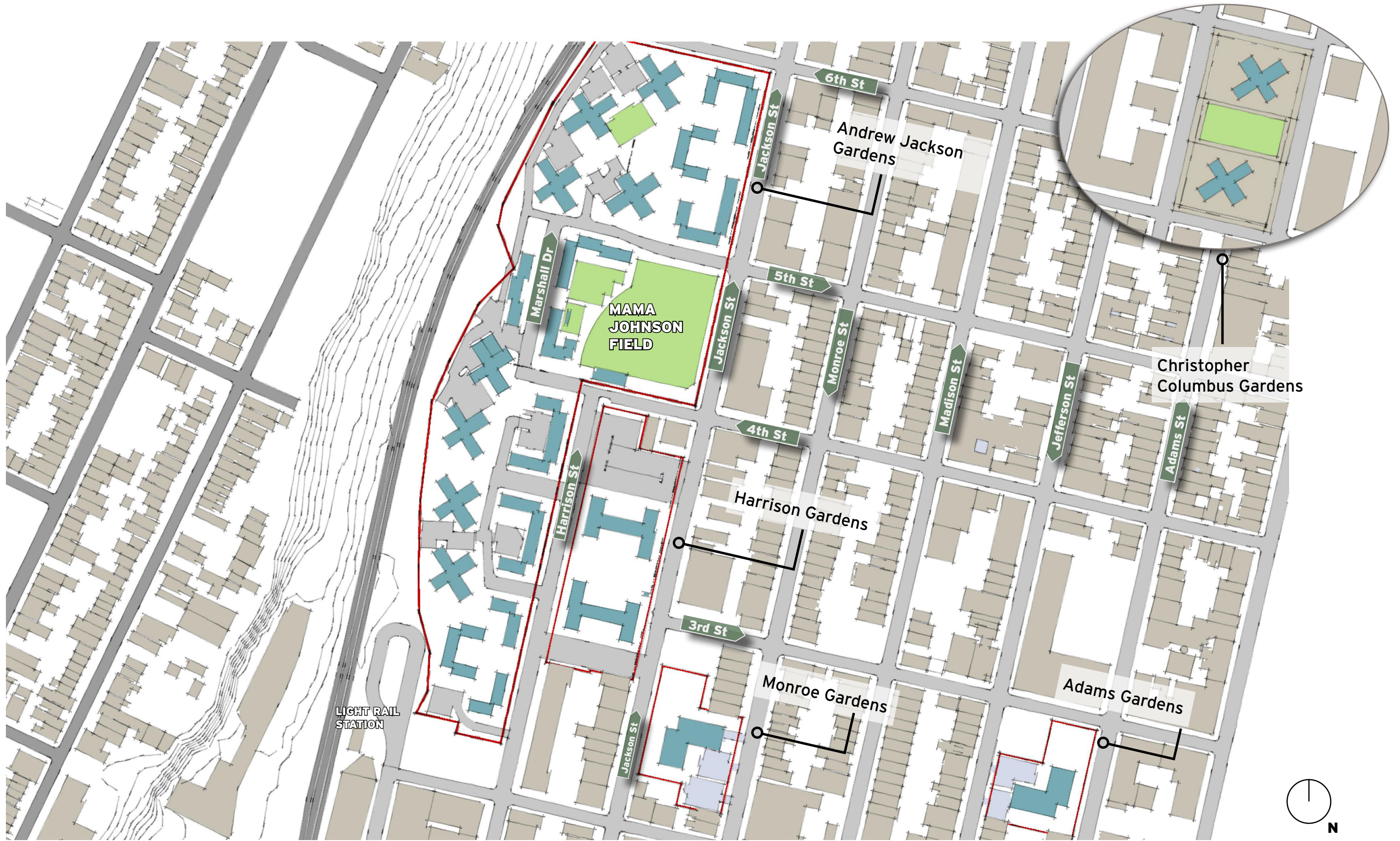



NOTES

1. THE CONTENT OF THIS DOCUMENT IS CONFIDENTIAL AND INTENDED ONLY FOR THE USE OF THE HOUSING AUTHORITY OF THE CITY OF HOBOKEN.
2. IT IS STRICTLY FORBIDDEN TO SHARE ANY PART OF THIS DOCUMENT WITH ANY THIRD PARTY, WITHOUT A WRITTEN CONSENT OF THE HOUSING AUTHORITY OF THE CITY OF HOBOKEN.

## Existing Conditions

HOUSING AUTHORITY OF THE CITY OF HOBOKEN

**HOBOKEN HOUSING FORWARD:** WORKSHOP SUMMARY

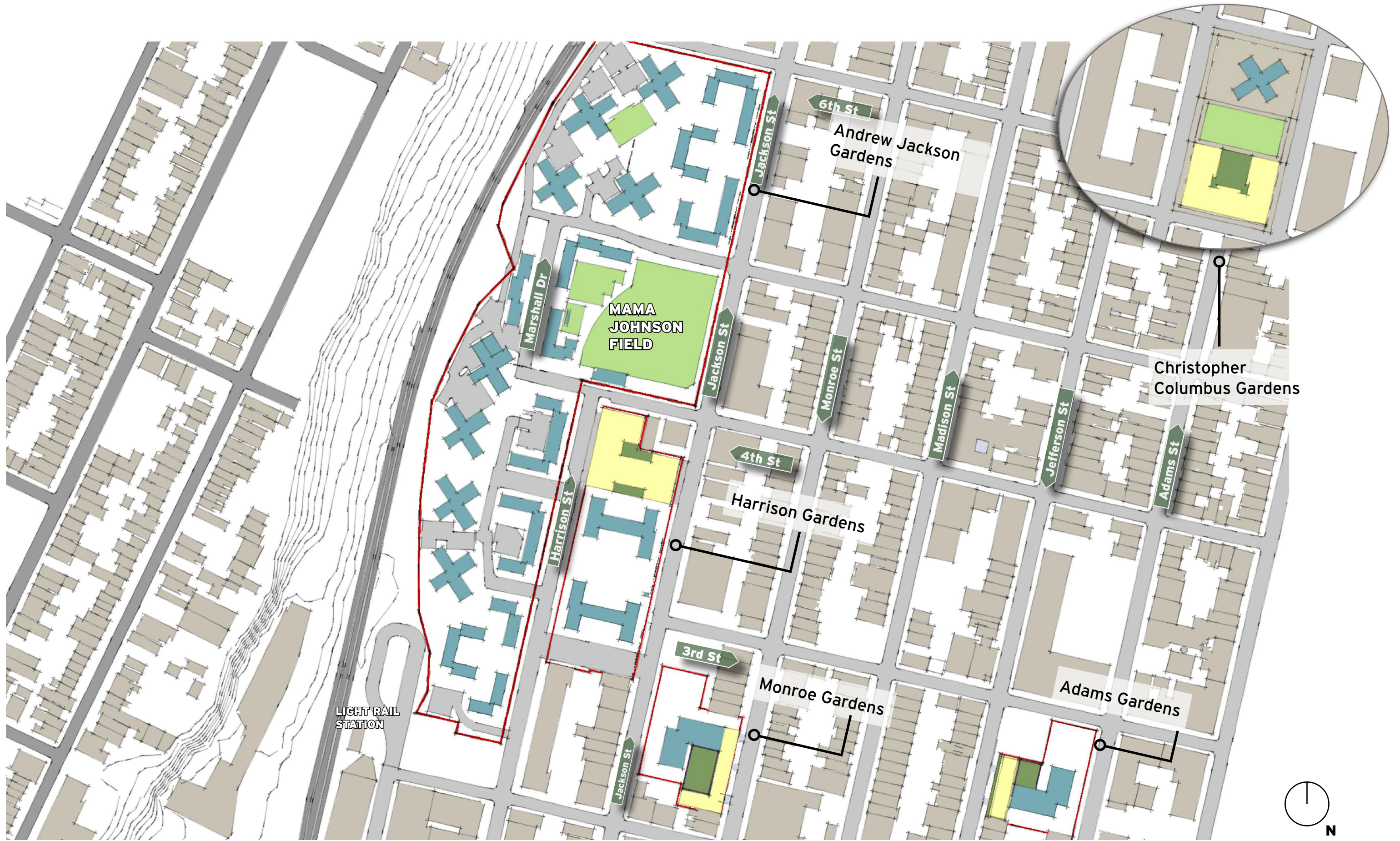



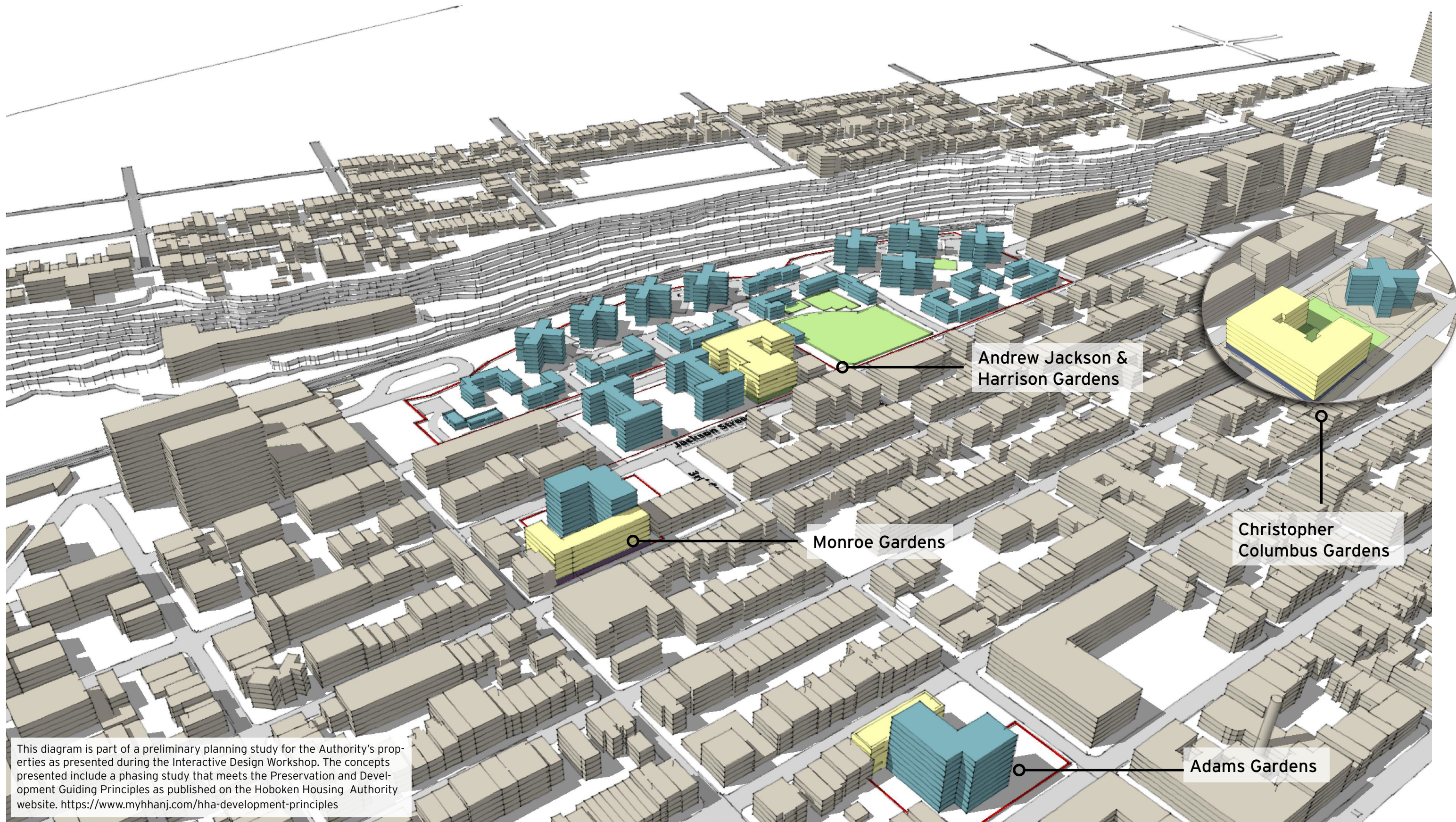

This diagram is part of a preliminary planning study for the Authority's properties as presented during the Interactive Design Workshop. The concepts presented include a phasing study that meets the Preservation and Development Guiding Principles as published on the Hoboken Housing Authority website. <https://www.myhhanj.com/hha-development-principles>

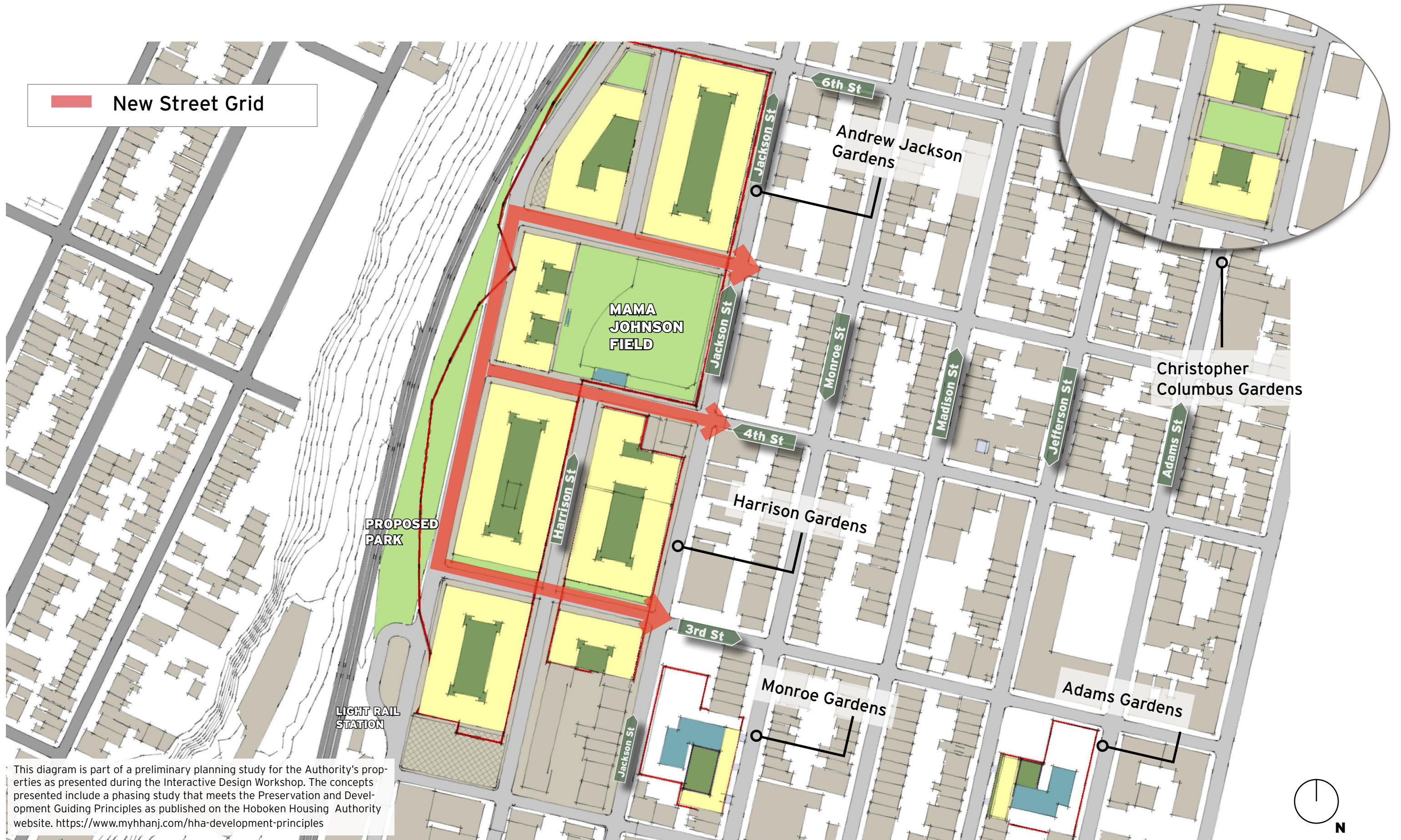

This diagram is part of a preliminary planning study for the Authority's properties as presented during the Interactive Design Workshop. The concepts presented include a phasing study that meets the Preservation and Development Guiding Principles as published on the Hoboken Housing Authority website. <https://www.myhhanj.com/hha-development-principles>



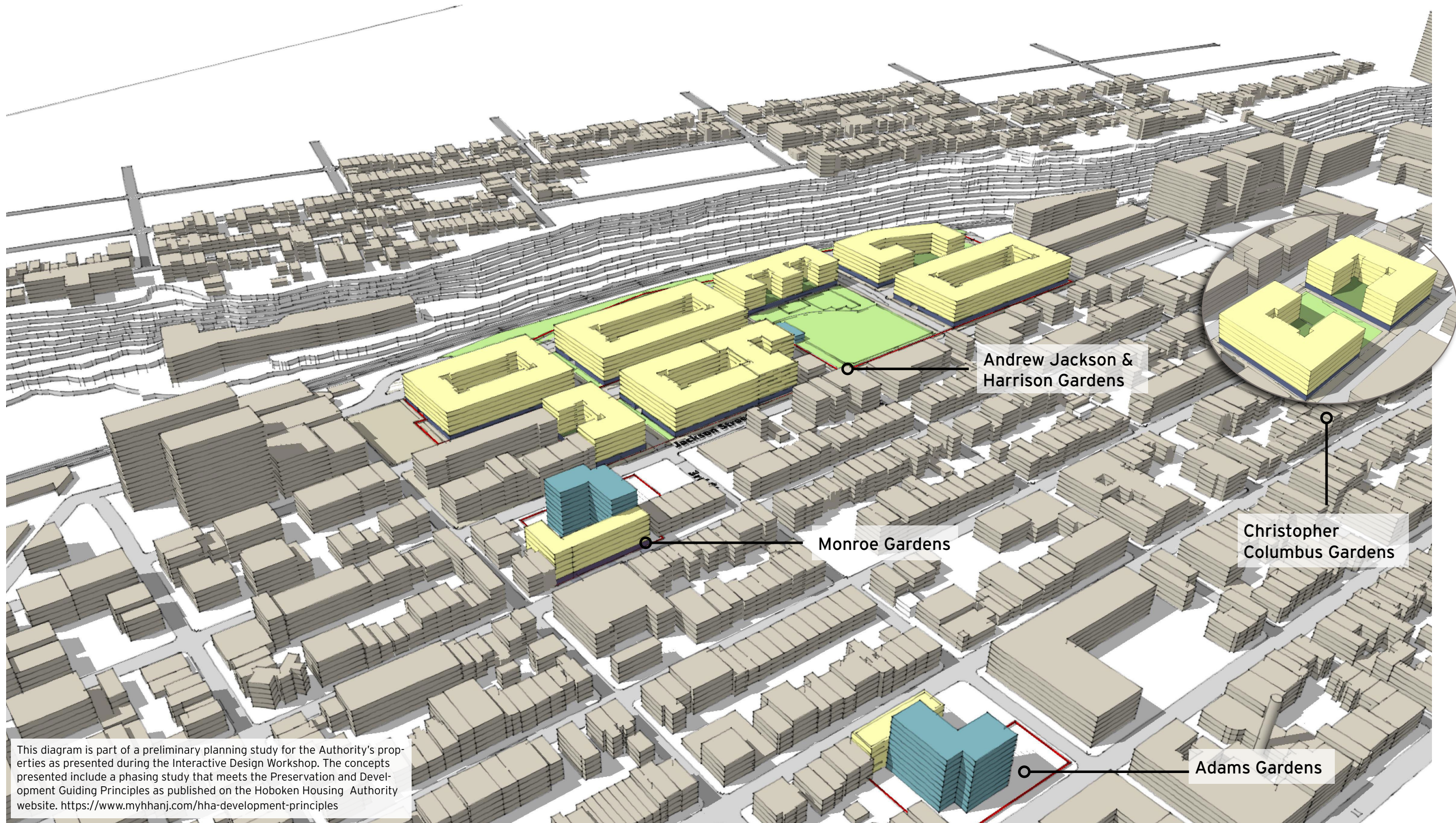

This diagram is part of a preliminary planning study for the Authority's properties as presented during the Interactive Design Workshop. The concepts presented include a phasing study that meets the Preservation and Development Guiding Principles as published on the Hoboken Housing Authority website. <https://www.myhhanj.com/hha-development-principles>

August 12, 2021 | Torti Gallas + Partners | 1923 Vermont Ave NW, 2nd Floor, Grimke School | Washington, DC 20001 | 301.588.4800



NOTES  
 1. THE CONTENT OF THIS DOCUMENT IS CONFIDENTIAL AND INTENDED ONLY FOR THE USE OF THE HOUSING AUTHORITY OF THE CITY OF HOBOKEN.  
 2. IT IS STRICTLY FORBIDDEN TO SHARE ANY PART OF THIS DOCUMENT WITH ANY THIRD PARTY, WITHOUT A WRITTEN CONSENT OF THE HOUSING AUTHORITY OF THE CITY OF HOBOKEN.